

GRADUATE
Commencement
2025



SUNY
Cortland

Welcome

The president, College Council, faculty, alumni and graduates of SUNY Cortland are honored by your presence at the 2025 Graduate Commencement ceremony.

TABLE OF CONTENTS

1	Program
	Candidates for Graduate Degrees
2	School of Arts and Sciences
2	School of Education
4	School of Professional Studies
6	Academic Traditions
7	Park Center Map and Facilities Information
8	Commencement Party
9	Graduate Commencement Committee
	Special Thanks
	College Council Members
9	Welcome to the Alumni Family
Back	Alma Mater

Park Center Alumni Arena
Friday, May 16, 2025

Program

Guests are kindly asked to silence their cell phones and other electronic devices during the ceremony.

PROCESSIONAL

Finger Lakes Brass Quintet

NATIONAL ANTHEM

Dr. Nancy J. Kane, *Adjunct Lecturer, Physical Education*

WELCOME

Dr. Erik J. Bitterbaum, *President*

FAREWELL REMARKS

Sigal Keren '23, M '25,
Communication Disorders and Sciences

CHARGE TO THE GRADUATES

Dr. Bitterbaum

CONFERRING OF DEGREES

Dr. Bitterbaum

Certificate of Advanced Study

Dr. Andrea Lachance, *Dean, School of Education*

Master's Degrees

School of Education

Dr. Lachance

School of Arts and Sciences

Dr. R. Bruce Mattingly, *Dean*

School of Professional Studies

Dr. Lynn MacDonald, *Interim Dean*

HOODING OF GRADUATES

Department Chairs, Program Coordinators and Faculty

ALUMNI ASSOCIATION WELCOME

Flossie Bell Lomax '86, M '90, C.A.S. '96, Ed.D.,
President, SUNY Cortland Alumni Association Board of Directors

ALMA MATER

Dr. Nancy J. Kane

RECESSIONAL

Finger Lakes Brass Quintet

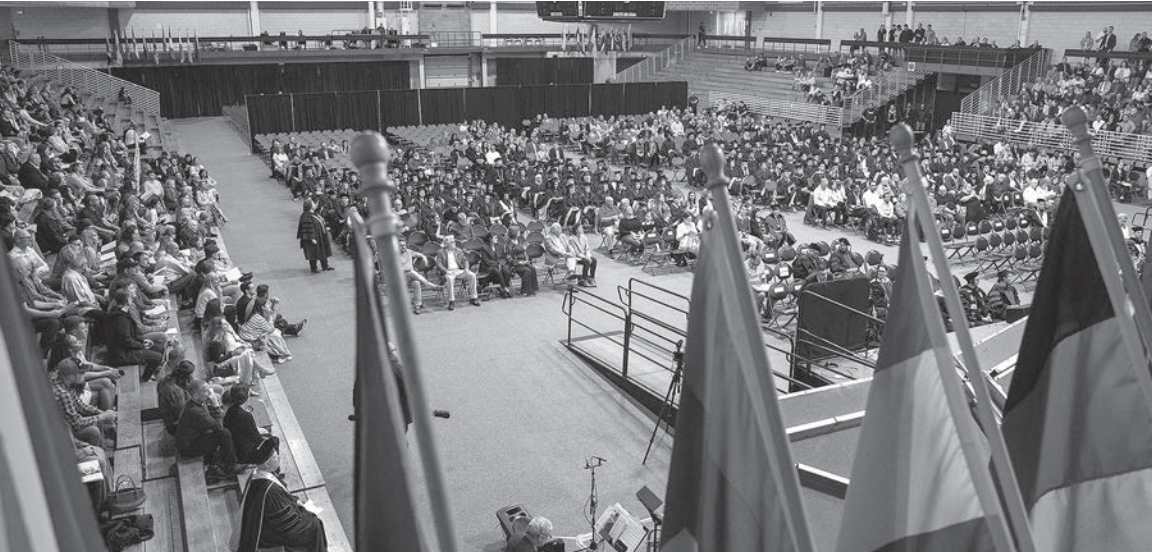

Candidates for Graduate Degrees

Candidates listed on the following pages completed their degree requirements in December 2024 or May 2025 or are expected to do so in August or December 2025. Candidates were required to apply for degree conferral by March 1 to appear in the printed program.

DEGREES AWARDED

C.A.S. Certificate of Advanced Study	M.A. Master of Arts
M.A.T. Master of Arts in Teaching	M.S. Master of Science
M.S.Ed. Master of Science in Education	M.S.T. Master of Science in Teaching

SCHOOL OF ARTS AND SCIENCES

ERIN BARRY

M.S.Ed., Second Language Education

JULIE BECKER

M.A., History

SHIARA BEERS

M.S.Ed., Second Language Education

ARIANNA BENEDETTO

M.S.Ed., Second Language Education

COLE BORT

M.A., History

AUSTIN COLUCCI

M.A.T., Adolescence Education:
English

MAURYSHA CUTTINO

M.A., English

ERIN DECKER

M.S.Ed., Second Language Education

CHRISTOPHER DUTCHER

M.A., History

DERRIAN FERNANDEZ

M.A., English

JAMES GIBBONS

M.A., History

JORDANNE GREENIDGE

M.A., English

ALLYSON GREIF

M.S.Ed., Second Language Education

ALLISON HALL

M.A., English

CASSANDRA HASKELL

M.A., English

EMMA HEPPNER

M.S.Ed., Second Language Education

BAILEY IACCARINO

M.A., History

SABRINA JAKOBSEN

M.A., History

MATTHEW KESSLER

M.A.T., Adolescence Education:
English

CAMERON KLINGENER

M.S.Ed., Second Language Education

JENNA LANGONE

M.A., History

SARA LOESER

M.S.Ed., Second Language Education

NOAH LOUGHLIN

M.A.T., Adolescence Education:
English

GEOFFREY PRESTON

M.A.T., Adolescence Education:
English

HARLEY MEYERS

M.A., English

DEVIN MURPHY

M.A., History

KELSEY QUINN

M.A., English

JULIA REYNOLDS

M.A., History

SELENA RIVERA

M.S.Ed., Second Language Education

LILY SIMMONS

M.S.Ed., Second Language Education

BRIAN THORNTON

M.A., English

SCHOOL OF EDUCATION

ABIGAIL ADAMS

M.S.T., Childhood Education

ABIGAIL ADAMS

M.S.Ed., Literacy Education

LAUREN ANDERSON

M.S.Ed., Literacy Education

STEPHEN ANDERSON

C.A.S., School Building Leader

DEANDRE BADRESINGH

M.S.T., Childhood Education

ADAM BARKER

M.S.Ed., Teaching Students with
Disabilities

JENNIFER BARTUNEK

M.S.Ed., Literacy Education

LINDSAY BERKELEY

C.A.S., School District Leader

HANNAH BLOWERS

M.S.Ed., Literacy Education

MACKENZIE BUCK

M.S.Ed., Teaching Students with Disabilities

DAVID BUSS

M.S.T., Childhood Education

ELIZABETH CALICCHIA

M.S.Ed., Literacy Education

ROBERT CAVELLI

M.S.T., Childhood Education

HALEIGH CLEVELAND

M.S.T., Childhood Education

NICOLE COLLINS

M.S.T., Childhood Education

JENNIFER CROWELL

M.S.T., Childhood Education

NATALIE D'AMELIO

M.S.Ed., Literacy Education

JULIE DAHLIN

M.S.T., Childhood Education

GABRIELLE DEFRANCO

M.S.Ed., Teaching Students with Disabilities

SOPHIA DIMAIO

M.S.T., Childhood Education

MADISON DIPALO

M.S.Ed., Literacy Education

JOSEPH DIPIAZZA

M.S.T., Childhood Education

KRISTIN FARLEY

M.S.Ed., Literacy Education

KAYLA FIGUEROA

M.S.Ed., Teaching Students with Disabilities

MEGHAN GIANNOTTA

M.S.Ed., Literacy Education

DIANNA GLASER

M.S.Ed., Literacy Education

MELISSA GOFF

M.S.Ed., Literacy Education

REBECCA GRESENS

M.S.Ed., Literacy Education

DONETTE GRIFFITH

M.S.T., Childhood Education

JYLENE GUABA

M.S.T., Childhood Education

JULIANNA HAGMAIER

M.S.Ed., Teaching Students with Disabilities

KAITLYN HARDLER

M.S.Ed., Teaching Students with Disabilities

ASHLEY HEIS

M.S.Ed., Literacy Education

MALLORY HEYDER

M.S.T., Childhood Education

SARAH HUNGERFORD

M.S.Ed., Teaching Students with Disabilities

ANGELA IANNACCHINO

M.S.T., Childhood Education

ANNABEL JACOBS

M.S.Ed., Literacy Education

KATELYN JAHELKA

M.S.T., Childhood Education

CASEY JASHEMBOWSKI

M.S.Ed., Literacy Education

CHRISTINA KANIA

M.S.Ed., Literacy Education

EMILY KEHOE

M.S.Ed., Literacy Education

ALYSSA KINNEY

M.S.T., Childhood Education

SOPHIA KLEOPOULOS

M.S.Ed., Literacy Education

KATELYN KLIMEKOSKI

M.S.T., Childhood Education

ANGELA KNIGHT

C.A.S., School Building Leader

KIARA KRUGER

M.S.Ed., Literacy Education

CATHRYN LALLY

M.S.Ed., Literacy Education

PATRICIA LANE

M.S.Ed., Literacy Education

AIYANA LEBRON

M.S.Ed., Literacy Education

ANGELINA LUNDY

M.S.Ed., Literacy Education

MICHELLE MAHONEY

C.A.S., School Building Leader;
School District Leader

ANN MANDEL

M.S.Ed., Literacy Education

ALEXANDRA MARRIOTT

M.S.Ed., Teaching Students with Disabilities

ROSELEA MARSH

M.S.Ed., Literacy Education

TARA MATTHIES

M.S.T., Childhood Education

BRIANA MCCANN

M.S.Ed., Literacy Education

NATALIE MCCORMICK

M.S.T., Childhood Education

DELANY MCDONALD

M.S.Ed., Teaching Students with Disabilities

SARAH MCGARRITY

M.S.Ed., Literacy Education

KAITLYN MCGUINNESS

M.S.T., Childhood Education

MADISON MCNALLY

M.S.Ed., Literacy Education

CHRISTINA MENDOZA

M.S.Ed., Literacy Education

MADISON MITCHELL

M.S.Ed., Literacy Education

TYLER MONELL

M.S.Ed., Literacy Education

JENNA MONTEAGUDO

M.S.Ed., Literacy Education

DOMINIQUE NIKAC

M.S.Ed., Literacy Education

HAILEY NILL

M.S.Ed., Teaching Students with Disabilities

ASHLEY O'DONNELL

M.S.Ed., Literacy Education

MACENZIE O'LEARY

M.S.T., Childhood Education

ALLISON ORZEL

M.S.T., Childhood Education

CAMERON OSTMEIER

M.S.T., Childhood Education

KORRYN PADDLEFORD

M.S.T., Childhood Education

VINNIE PAGE

C.A.S., School Building Leader

LORRAINE PASCARELLA

C.A.S., School Building Leader;
School District Leader

JULIANA PEEK

M.S.Ed., Literacy Education

JENNIFER PERRY

M.S.T., Childhood Education

KAYLA PINAUD

M.S.Ed., Literacy Education

BENJAMIN PINCHAK

M.S.Ed., Literacy Education

ANNE PINKERTON

M.S.Ed., Literacy Education

KASSIDEE PODEST

M.S.Ed., Literacy Education

DANIELLE RATOWSKY

M.S.Ed., Literacy Education

SHANNAN RAYNOR

M.S.Ed., Literacy Education

MADISON RICE

M.S.Ed., Teaching Students with Disabilities

ANGELINA ROHRLE

M.S.Ed., Teaching Students with Disabilities

SAVANNAH RUSWEILER

M.S.Ed., Literacy Education

TAYLOR RYNDERS

M.S.T., Childhood Education

KYLIE SALAMIDA

M.S.T., Childhood Education

JENNIFER SAMPATH

M.S.T., Childhood Education

TERESA SARRICA

M.S.Ed., Teaching Students with Disabilities

MEGHAN SCARRY

M.S.Ed., Literacy Education

BARRY SCHECTER

M.S.T., Childhood Education

KRISTAN SHEPPARD

C.A.S., School Building Leader;
School District Leader

MICHELLE SLATER

M.S.T., Childhood Education

BRITTANY SMALLWOOD

M.S.T., Childhood Education

PAIGE SMITH

M.S.Ed., Literacy Education

ALLISON SNYDER

M.S.T., Childhood Education

ALEXANDRA SOKOLOWSKI

M.S.Ed., Literacy Education

SHAYNE SOLTIS

M.S.T., Childhood Education

SAMANTHA SPENCER

M.S.Ed., Literacy Education

TARIN SUSSMAN-KIM

M.S.T., Childhood Education

SHANE TAYLOR

C.A.S., School Building Leader

TIFFANY TESSEYMAN

M.S.Ed., Teaching Students with Disabilities

MORGAN THAILER

M.S.Ed., Literacy Education

MADILYN TIDERENCEL

M.S.Ed., Literacy Education

OLIVIA VANOLST

M.S.Ed., Literacy Education

MORGAN VICKERY

M.S.Ed., Literacy Education

MARIASOPHIA VIGLIOTTI

M.S.T., Childhood Education

HAYLEE WADE

M.S.Ed., Literacy Education

ALEXI WALTS-GEORGE

M.S.Ed., Teaching Students with Disabilities

SARA WEBER

M.S.Ed., Literacy Education

RILEY-MADISON WEINBERG

M.S.Ed., Literacy Education

MAEGHAN WESTMILLER

M.S.Ed., Literacy Education

BRITTNEY WILLIAMS

M.S.T., Childhood Education

HALEY YEGIDIS

M.S.Ed., Teaching Students with Disabilities

**SCHOOL OF
PROFESSIONAL STUDIES****MADELINE ACEVEDO**

M.S.T., Physical Education

MOHAMMADREZA AFKHAMI

M.S., Exercise Science

KENDRA ANDERSON

M.S., Athletic Training

NICHOLAS ANNESI

M.S., Athletic Training

NATALIA AQUINO

M.S., Exercise Science

KYLE ARTURA

M.S.T., Health Education

MICHAELA ASARO

M.S., Recreation

JENNA BARDIN

M.S., Communication Sciences
and Disorders

Aidan Bernal

M.S.T., Health Education

 Keara Blumenstock

M.S., Communication Sciences
and Disorders

 Marisa Bogdonoff

M.S., Athletic Training

 Logan Brown

M.S., Sport Management

 Thomas Burek

M.S.T., Health Education

 Alexandra Butterfield

M.S., Community Health

 Tanner Cain

M.S.T., Physical Education

 Kaitlyn Cinelli

M.S., Exercise Science

 Franco Colantuono

M.S.T., Health Education

 Daijah Colvin

C.A.S., Therapeutic Recreation

 Alyssa Coscia

M.S., Communication Sciences
and Disorders

 Katherine Cosenza

M.S.T., Health Education

 Aubrey Craig

M.S., Communication Sciences
and Disorders

 Nicolette D'Alessio

M.S.Ed., Physical Education
Leadership

 Andrew Damo

M.S., Sport Management

 Jaden Datz

M.S., Sport Management

 Olivia Davis

M.S., Sport Management

 Sidney Demagistris

M.S., Sport Management

 Madison Desmarais

M.S., Communication Sciences
and Disorders

 Sage Diaz

M.S., Communication Sciences
and Disorders

 Mackenzie Dickman

M.S., Community Health

 Meaghan Doyle

M.S., Communication Sciences
and Disorders

 Devin Drew

M.S., Athletic Training

 Casey Dunbar

M.S.T., Health Education

 Joseph Ferrone

M.S.T., Physical Education

 Emma Fredenburg

M.S., Community Health

 Danielle Fisk

M.S., Athletic Training

 Kathryn Fleming

M.S., Communication Sciences
and Disorders

 Emma Fredenburg

M.S., Community Health

 Tyler French

M.S.T., Health Education

 Carter Galle

M.S.T., Health Education

 Cole Gianguzzi

M.S.T., Health Education

 Zachary Goodman

M.S., Sport Management

 Michael Greco

M.S., Sport Management

 McKayla Hamilton

M.S.T., Physical Education

 Gregory Hartwich

M.S.T., Physical Education

 Jason Haselkorn

M.S., Sport Management

 Cathleen Higgins

M.S.T., Health Education

 Jenna Hood

M.S., Communication Sciences
and Disorders

 Paige Isbell

M.S., Sport Management

 Kate Jensen

M.S., Recreation

 Aaron Jones

M.S., Exercise Science

 Payton Jones

M.S., Athletic Training

 Devin Jurkiewicz

M.S.T., Physical Education

 Sigal Keren

M.S., Communication Sciences
and Disorders

 Andrew Kessler

M.S., Exercise Science

 Dylan Kilpatrick

M.S., Sport Management

 Kyle Klein

M.S.T., Health Education

 Ryan Kocher

M.S.T., Health Education

 Thomas Kress

M.S.T., Health Education

 Alyson Krotenberg

M.S., Therapeutic Recreation

 Jessica Kwasnik

M.S.T., Health Education

 Emmalyn Lapiere

M.S.T., Physical Education

 Alex Lessman

M.S.T., Health Education

 Kylie Letham

M.S., Communication Sciences
and Disorders

 James Liberatore

M.S., Sport Management

 Connor Lofrese

M.S.T., Health Education

 Lily Logan

M.S., Recreation

DREW MANFREDI

M.S., Communication Sciences
and Disorders

MCKAYLA MARONEY

M.S., Athletic Training

JULIA MARTINS

M.S.T., Physical Education

JILLIAN MASSIMINO

M.S., Therapeutic Recreation

ZARIA MCCULLOUGH

M.S., Sport Management

JALEN MENTION

M.S.T., Physical Education

JOSEPH MEYER

M.S.T., Health Education

CHRISTOPHER MUELLER

M.S., Sport Management

TRAVIS MUHLNICKEL

M.S.T., Health Education

RYAN MURLING

M.S., Exercise Science

COLIN OCZKOWSKI

M.S.T., Health Education

AIDEN POLI

M.S.T., Health Education

CARTER POOLER

M.S., Sport Management

RAYSHAWN POWELL

M.S., Sport Management

GRACE QUICK

M.S.T., Health Education

TARYN RAISANEN

M.S., Community Health

VICTOR RAMIREZ

M.S., Exercise Science

ANNA REINSHAGEN

M.S., Athletic Training

MICHAEL ROGERS

M.S., Athletic Training

NICOLE RYAN

M.S., Athletic Training

VINCENT SANGIUOLO

M.S.Ed., Physical Education
Leadership

CLAYTON SANTIAGO

M.S.T., Health Education

JEAN-ANDRE SASSINE

M.S., Sport Management

ADAM SCHREIBER

M.S., Sport Management

JUSTIN SCHROM

M.S., Sport Management

GABRIEL SHORT

M.S.T., Physical Education

KYLE SICKE

M.S.T., Physical Education

SYDNEY SMITH

M.S., Communication Sciences
and Disorders

DANIELLE SOMMERS

M.S.T., Health Education

KARA SPATH

M.S., Athletic Training

CHLOIE SPRAKER

M.S., Communication Sciences
and Disorders

ALYSSA STEVENSON

M.S., Athletic Training

CAMRYN STONE

M.S.T., Health Education

ZACHARY TARO

M.S., Exercise Science

DIANA TER BUSH

M.S., Sport Management

MIKAYLA TORREY

M.S., Communication Sciences
and Disorders

MARGARET TOWSLEY

M.S., Communication Sciences
and Disorders

JESSICA TRIPP

M.S., Recreation

SADIE URTZ

M.S., Sport Management

GINO VACCARO

M.S.T., Health Education

PRESTON VAN WIE

M.S., Sport Management

CARLY VATTER

M.S., Communication Sciences
and Disorders

HALLE VERCILLO

M.S.T., Health Education

BENJAMIN WALTERS

M.S.T., Physical Education

MARK WEIDMAN

M.S.T., Health Education

BRADY WEINGARTNER

M.S.T., Health Education

ABIGAIL WILKINSON

M.S.T., Health Education

HALEY WILTON

M.S., Athletic Training

NATALIE WUNDER

M.S., Communication Sciences
and Disorders

CHLOE ZEEUW

M.S., Exercise Science

Academic Traditions

ACADEMIC PROCESSION

The processional begins with the all-university gonfalonier, who leads in the faculty, followed by the schools of Arts and Sciences, Education and Professional Studies gonfaloniers, who lead in the students. The processional concludes when the mace bearer brings in the platform party, which consists of members of the administration and faculty leadership, the College Council, visiting dignitaries and honorees.

THE MACE

The mace is a ceremonial staff used as a symbol of authority. The mace bearer precedes the platform party and places the mace on a special stand where it remains while the official proceedings of Commencement are underway. SUNY Cortland's mace, the "Torch of Learning," is made of silver and rosewood and was created by local silversmith John Marshall.

THE GONFALONS

The four bright banners carried in the academic procession are called gonfalons. The red, white, black and grey gonfalon represents SUNY Cortland; in blue, grey and burgundy it represents the School of Arts and Sciences; in blue, purple and black it represents the School of Education; and in peach and green it represents the School of Professional Studies.

The gonfalons were designed by Libby Kowalski, professor emerita of art and art history, and Kathy Maher '84. The standards were made by the late Bard Prentiss, associate professor emeritus of art and art history, and J. Eric Kroot. Materials were provided by the Gilbert and Mary Cahill Foundation and the late Rozanne M. Brooks, distinguished teaching professor emerita of sociology/anthropology.

REGALIA

Commencement lends itself to the pageantry of an academic procession rooted in medieval times. The gowns and hoods worn by faculty members, candidates for graduation and platform dignitaries distinguish the institution from which the wearer was or will be graduated, the level of the degree earned and the field of learning.

In 1985, American colleges established a standard code of academic dress, specifying three types of gowns. The gown for the bachelor's degree has pointed sleeves, the gown for the master's degree has an oblong sleeve with the front part cut in an arc, and the gown for the doctoral degree has bell-shaped sleeves. The doctoral gown also is trimmed in velvet. The hood's inner lining, which folds out at the back and center, indicates the colors of the institution granting the degree, while the border, which comes around to

the front of the neck, represents the field of learning.

The black mortarboard cap is standard. Its only distinguishing feature is a gold tassel worn by holders of the doctoral degree.

PRESIDENTIAL MEDALLION

The silver medallion worn by the president at Commencement was designed by the late Gerald DiGiusto, professor of art and art history, and crafted by artist Linda Stewart in a project supported by the late Rozanne M. Brooks, distinguished teaching professor emerita of sociology/anthropology. It depicts the seven valleys of Cortland County.

THE KENTE STOLE

The Kente stole is a rich, multicolored, handwoven style of cloth that originated in Ghana, West Africa, and is revered throughout the Africana world. It is traditionally worn during important national ceremonies. The colors, patterns and ideogrammatic images of the Kente stole impart information about the wearer and highlight the importance of an event or a ceremony. Similar to the academic hood, the Kente stole is relatively new to commencement ceremonies in the United States and symbolizes higher education's connection to the rich cultures, intellectual traditions and academic achievements of the Africana world.

SPECIAL PERSON DESIGNATION

All graduates can designate a special person who has been instrumental in helping them achieve their higher education goals. This individual's name is read along with the graduate's name as they walk across the stage at the Commencement ceremony. Students who choose to name a special person do so when they apply for their degree.

INTERNATIONAL FLAG PRESENTATIONS

Graduating students representing countries from around the world have the opportunity to present their national flag to the provost during the Commencement ceremony. In the past, flags representing Afghanistan, Australia, Azerbaijan, Bangladesh, Belize, Canada, Chile, China, Colombia, Cyprus, Egypt, Finland, France, Germany, Ghana, Grenada, Haiti, India, Iran, Ireland, Italy, Jamaica, Japan, Kenya, Lebanon, Malaysia, Nepal, Nigeria, Peru, Poland, Republic of Congo, Romania, Russia, South Africa, South Korea, St. Lucia, Sweden, Thailand, The Gambia, Turkey and the United Kingdom were received. The 2025 ceremonies will feature the flags of Turks and Caicos, Ghana and Iran. Flags are displayed on stage during the ceremony and afterward they are exhibited in the lobby of Corey Union and the foyer of Old Main.

Park Center Map and Facilities Information

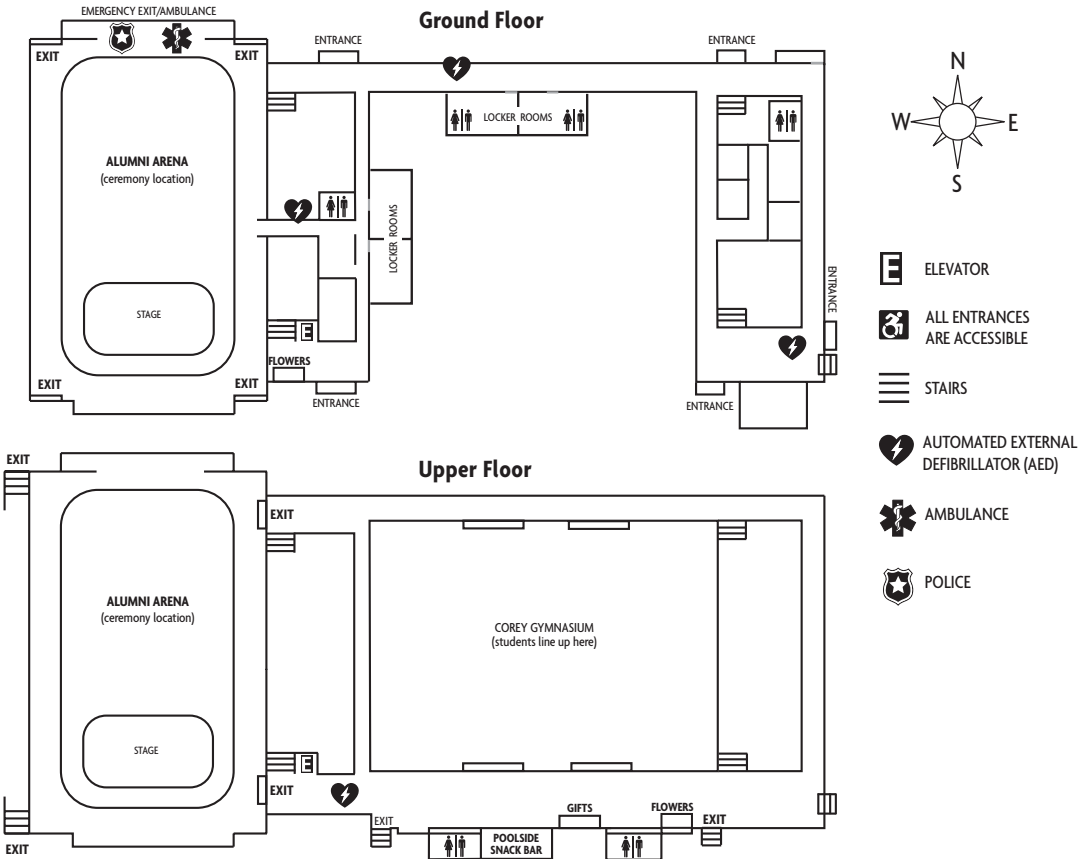

AMBULANCE

An ambulance will be stationed in the northwest parking lot of the Park Center, just outside the overhead door.

EMERGENCY EXITS

In case of emergency, please proceed to the nearest exit in an orderly manner.

EMERGENCY PHONES

Locations on campus are identified by blue lights.

FLOWERS AND GIFTS

Campus Store staff will be selling flowers, diploma frames and assorted gifts on the upper and ground floors of Park Center from 5:30-8:30 p.m. See map for locations.

GUEST ASSISTANCE

Ushers are available for assistance and information.

LOST AND FOUND

For lost and found items, please contact the University Police Department, Whitaker Hall, Room 110, 607-753-2112.

PHOTOGRAPHY

Please stand to the side of the stage when taking pictures to avoid blocking the view of seated guests.

REFRESHMENTS

Refreshments may be purchased on the upper floor of the Park Center at the Poolside snack bar. Bottled water also is available for purchase on the ground floor of Park Center.

RESTROOMS

Park Center restrooms are indicated on the map.

SMOKING

Smoking and tobacco use are not permitted on campus.

Commencement Party

MACE BEARER

Dr. Kathleen Lawrence
*Chair, Faculty Senate
Professor, Communications
and Media Studies*

GONFALONIERS

All-University

Dr. Lori Reichel
Assistant Professor, Health

Arts and Sciences

Dr. Vincent DeTuri
Associate Dean

Education

Dr. Kimberly Rombach '88, M '93
Associate Dean

Professional Studies

Dr. Susan Wilson
Associate Dean

MARSHALS

Platform Party

Dr. Andrea Lachance
Dean, School of Education

Dr. Lynn E. MacDonald
*Interim Dean, School of
Professional Studies*

Dr. R. Bruce Mattingly
Dean, School of Arts and Sciences

Faculty

Dr. Peter McGinnis
*Distinguished Service Professor,
Kinesiology*

Students

Dr. Carol Van Der Karr
*Vice Provost, Academic Affairs
and Institutional Effectiveness*

Daniela Baban Hurre
Director, International Programs

At-Large

Michael Bersani
*Communications Officer,
President's Office*

Raven Clessa

*Technology Support Specialist,
The Help Center*

Nancy Diller

*Curriculum Coordinator,
Academic Affairs*

Dr. Amy Dizenzo

*Associate Professor, Recreation,
Parks and Leisure Studies
Department*

Patrick Donnelly '01

Instructor, Kinesiology

Dr. Xiaoping Fan

*Assistant Professor,
Physical Education*

Michael Foki

*International Student Advisor,
International Programs*

Dr. John Foley

*Distinguished Professor,
Physical Education*

Dr. Jacob Hall

*Associate Professor, Childhood/
Early Childhood Education*

Dr. Christina M. Knopf

*Professor, Communication and
Media Studies*

Dr. Nimisha Muttiah

*Assistant Professor,
Communications Disorders
and Sciences*

Justin Neretich '17

*Community Engagement and
Academic Coordinator,
Extended Learning Office*

Dr. Jason Page '08, M '12

*Assistant Professor, Recreation,
Parks and Leisure Studies*

Dr. Katherine M. Polasek

Professor and Chair, Kinesiology

Dr. Carol Van Der Karr

*Vice Provost, Academic Affairs
and Institutional Effectiveness*

Dr. Ryan Vooris '08

*Associate Professor and Chair,
Sport Management*

Dr. Jeffrey Walkuski

*Associate Professor,
Physical Education*

Dr. Kim Wieczorek

*Associate Professor and Chair,
Childhood/Early Childhood
Education*

READER

Jack Carr

*Lecturer IV, Communication
and Media Studies*



Graduate Commencement Committee

Michael Bersani
Mikaela Blackman
Daniel Condon
Frank Cullen '06
Tracey DelVecchio
John Donovan
Daniel Dryja '04
Dr. Patricia Francis
Carolynn MacNay-Knight
Tanya Maggs
Todd Malone '11
Dr. Peter McGinnis, *chair*
Daniel Poorman
Philip Roys
Bradford Snyder
Jennifer Stiles
Alyssa Wakula '22
Dr. Kim Wieczorek

SPECIAL THANKS

Administrative Computing Services
Campus Event Management
Custodial Services
Division of Institutional Advancement
Duplicating Center
Facilities Operations and Services
Information Systems and Security
Marketing Office
Registrar's Office
Student Ushers
SUNY Cortland Alumni Association
SUNY Cortland Auxiliary Services Catering
The Campus Store
University Police Department

COLLEGE COUNCIL MEMBERS

Linda May Armstrong '76
Liz Arnold
Lynn Brown '99, M '03
Thomas Gallagher, *chair*
Andrea Haenlin-Mott
Renee L. James, Esq. '82
John Reagan
Adrianne Traub
Bruce R. Tytler M '88, C.A.S. '05

Welcome to the Alumni Family

SUNY Cortland has graduated more than 90,000 students, and you are joining the ranks of alumni who reside in all 50 states and nearly 60 countries. We encourage you to continue your involvement with your alma mater through our reunion programs, regional events and special gatherings.

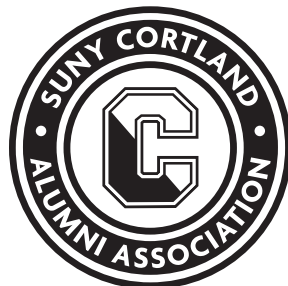

By keeping Alumni Engagement updated with your current residential and email addresses, you will be assured of receiving event invitations and publications such as our alumni magazine, *Columns*, and online newsletter, *Red Dragon Tales*. Scan the QR code or visit RedDragonNetwork.org/update to register your alumni profile.



Stay connected with SUNY Cortland, friends and classmates by following the Alumni Association's Facebook, LinkedIn, Instagram and X accounts.

Please visit RedDragonNetwork.org for details about alumni events and much more. Watch for information about programming tailored to our newest alumni.

We are pleased to have you as a member of the SUNY Cortland Alumni Association and wish you a bright and successful future.



Lynne Parks '68 SUNY Cortland Alumni House

Alma Mater

By lofty elm trees shaded round,
Tioughnioga near,
Our grand old Cortland College stands,
To all of us how dear!
We'll sing to thee, dear Alma Mater,
Of love that shall never die,
We'll strive for thy glory eternal,
Keep thy stainless honor high.
Inspiring each son and each daughter
The noblest aims to try,
All thy fame and thy spirit,
Thy might are ours
As the swift years hurry by.



Share your Commencement photos

#Cortland25



COMMENCEMENT SURVEY

Please give us your thoughts by taking a short online survey. Your feedback is valuable as we plan future events. Scan the QR code or visit

→ cortland.edu/commencement

The SUNY Cortland logo, featuring the word "Cortland" in a large, white, serif font, with "SUNY" in a smaller, white, sans-serif font above it, all set against a red rectangular background.